

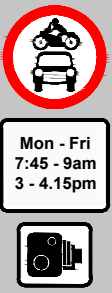

TRAFFIC ENFORCEMENT CAMERA AND SIGNAGE TO BE PLACED ON NEW 6m POLE. SUBJECT TO TESTING

PROPOSED HEALTHY SCHOOL STREET FOLDING SIGNS TO BE PLACED ON NEW 4m SIGNAGE POLES



TRAFFIC ENFORCEMENT CAMERA AND SIGNAGE TO BE PLACED ON NEW 6m POLE. SUBJECT TO TESTING

PROPOSED HEALTHY SCHOOL STREET FOLDING SIGNS TO BE PLACED ON NEW 4m SIGNAGE POLES

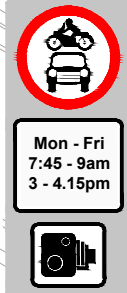

PROPOSED HEALTHY SCHOOL STREET FOLDING SIGNS TO BE PLACED ON NEW 4m SIGNAGE POLES

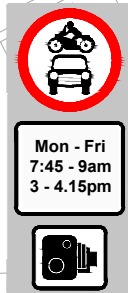

REMOVAL OF PARKING BAY ON RAISED TABLE TO IMPROVE VISIBILITY

PROPOSED FOOTWAY BUILD-OUT AT CROSSING POINT

EXISTING FOOTWAY WIDENING MATERIAL TO BE REPLACED AND CYCLE RACKS AND TREES TO BE ADDED
 POSSIBILITY OF FUTURE SUSTAINABLE URBAN DRAINAGE ARRANGEMENT TO BE INVESTIGATED BY CAMDEN COUNCIL

TRAFFIC ENFORCEMENT CAMERA AND SIGNAGE TO BE PLACED ON EXISTING LIGHTING COLUMN. SUBJECT TO TESTING

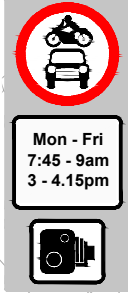

PROPOSED HEALTHY SCHOOL STREET FOLDING SIGNS TO BE PLACED ON NEW 4m SIGNAGE POLES

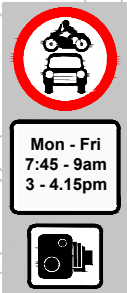

PROPOSED HEALTHY SCHOOL STREET FOLDING SIGNS TO BE PLACED ON NEW 4m SIGNAGE POLES

TRAFFIC ENFORCEMENT CAMERA AND SIGNAGE TO BE PLACED ON EXISTING LIGHTING COLUMN. SUBJECT TO TESTING

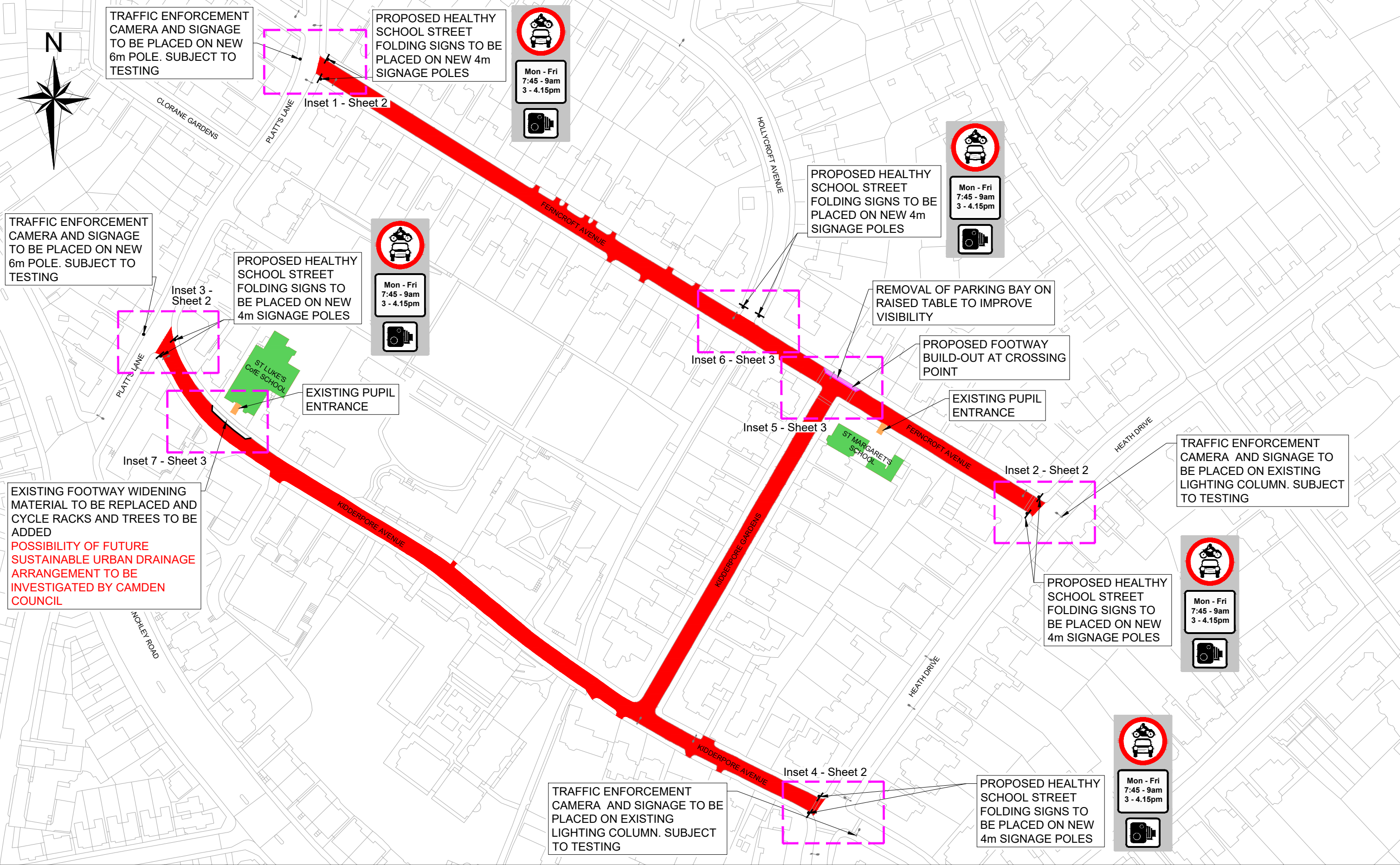

Camden
 Design Team
 Transport Strategy Service
 London Borough of Camden
 5 Pancras Square
 Tel 020 7974 5551, Fax 020 7974 6952
 DX 2106 Euston, Minicom 020 7974 6866

Project
 London Borough of Camden
 Healthy School Streets
 Phase 6
 Drawing Title
 Kidderpore & Ferncroft Avenue
 Public Consultation - Scheme Overview
 Sheet 1 of 4

Key
 ● Existing lighting column
 ■ Existing Pupil Entrance
 ● Proposed Signage Pole
 — Proposed Signage
 ■ Proposed Timed Road Closure Area

Rev	By	Date	Amendments

Scale
 NTS @ A3
 Drawn By
 JR
 Checked By
 JA
 Drawing Location
 Drawing Number
 Date
 APR 23
 File Ref
 Dwg Name
 Rev.
A

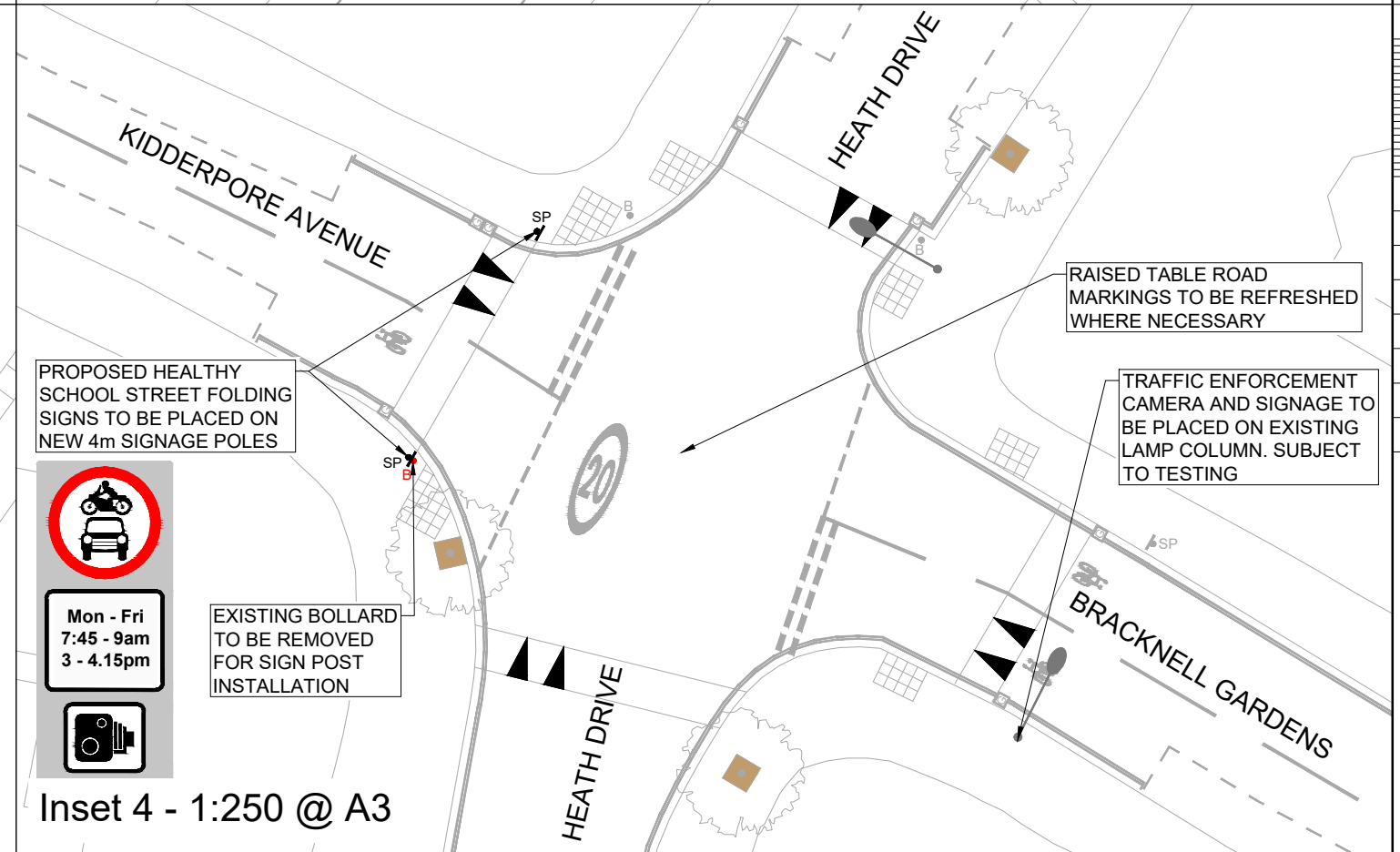
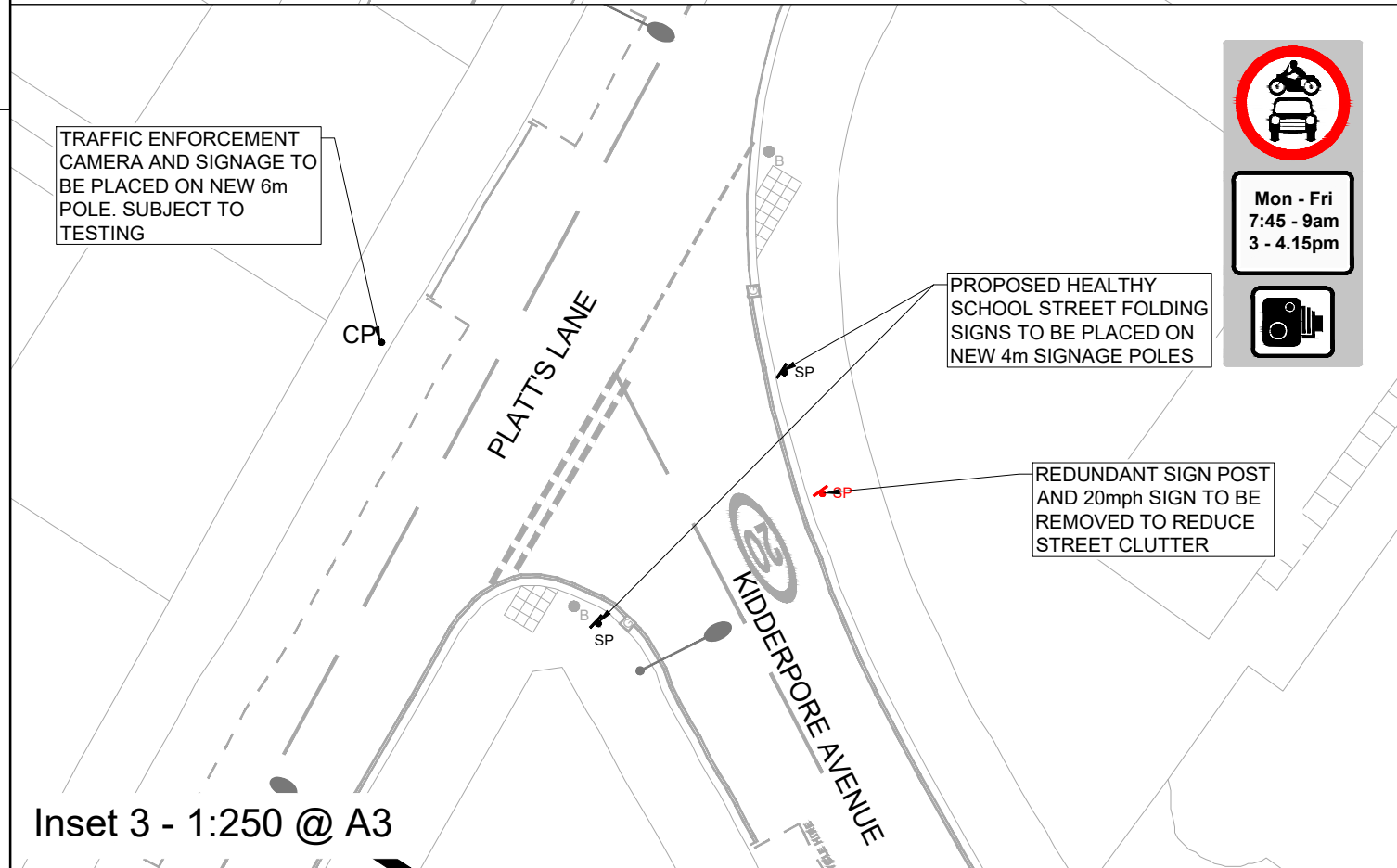
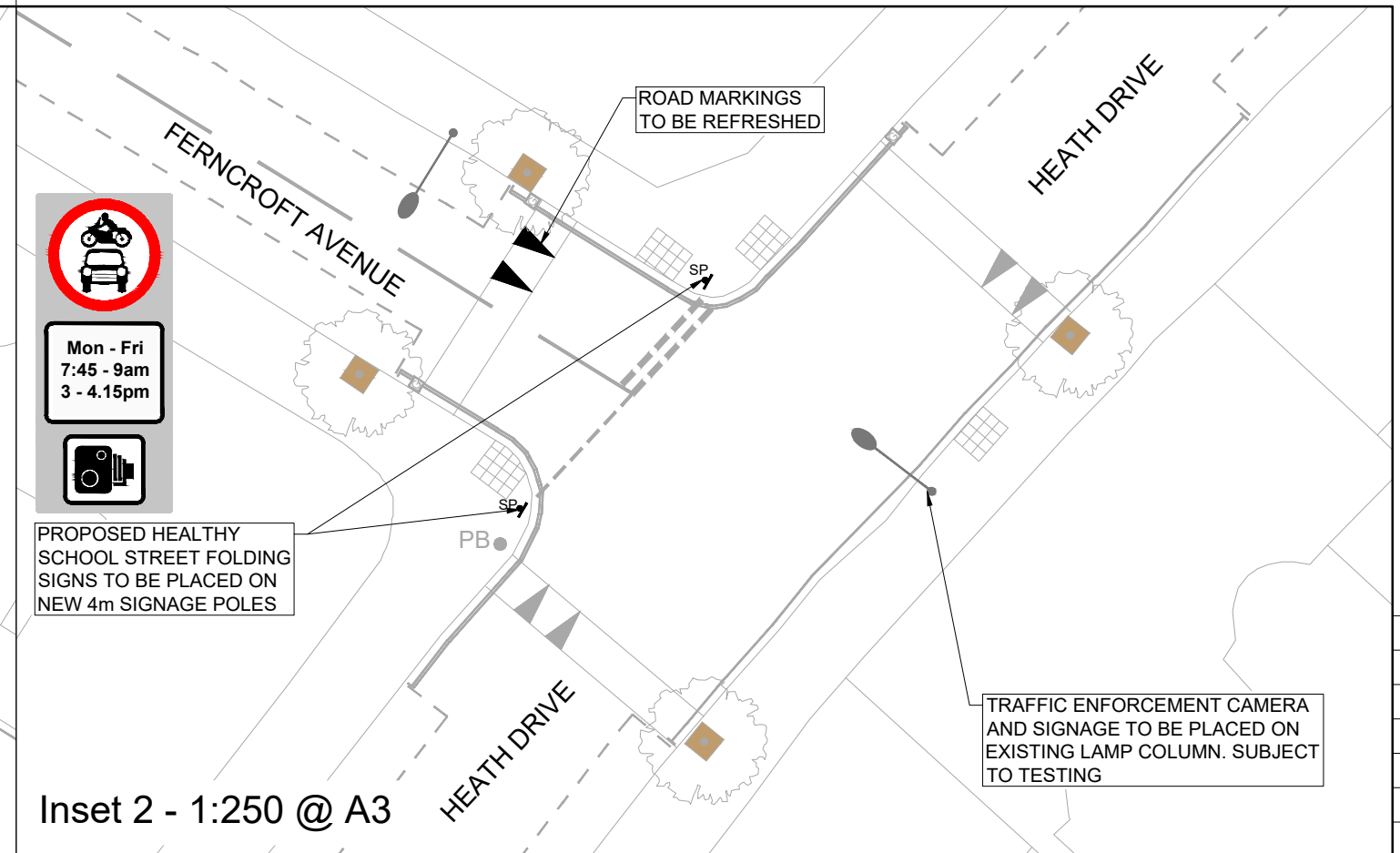
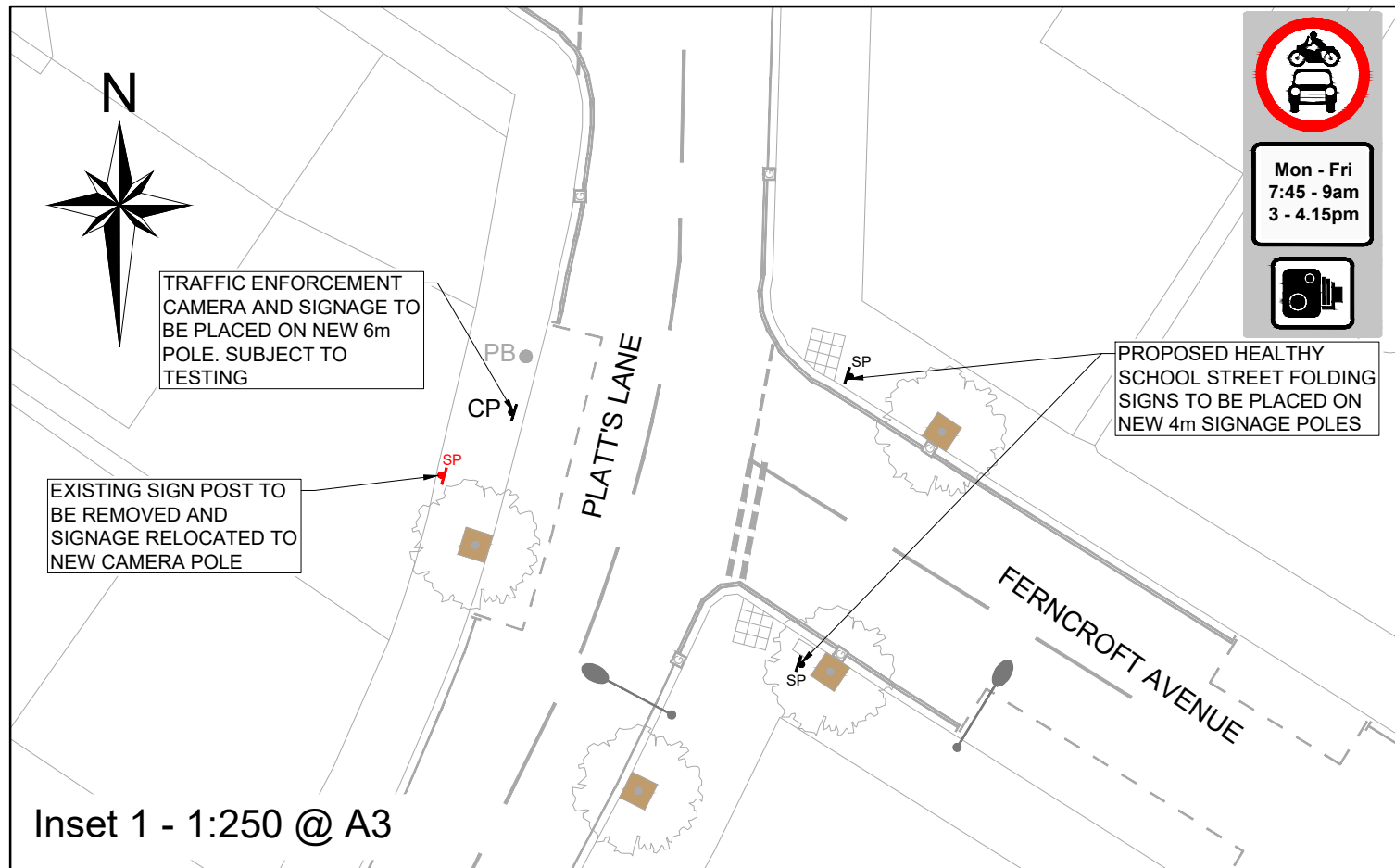

Rev	By	Date	Amendments

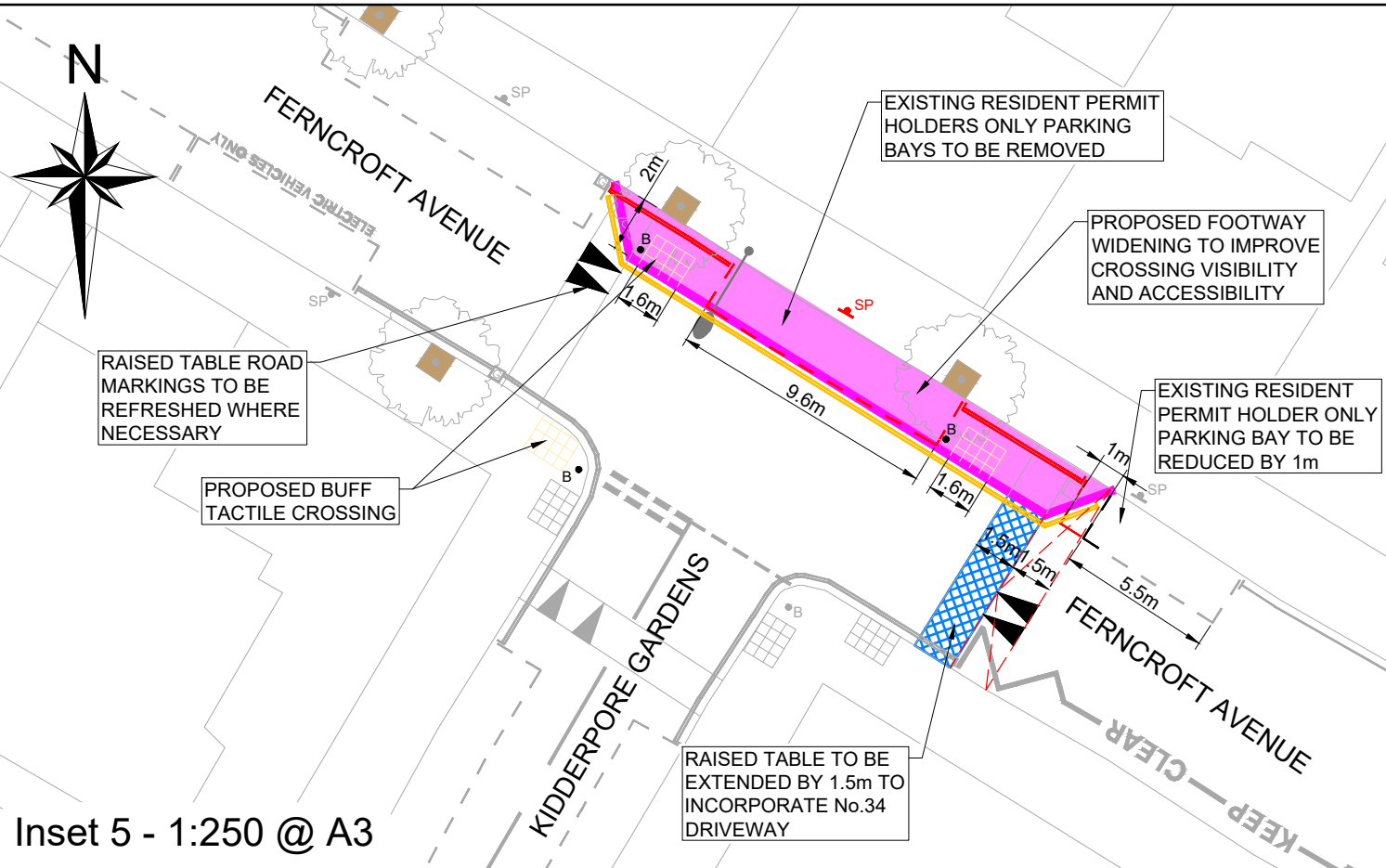

Inset 5 - 1:250 @ A3

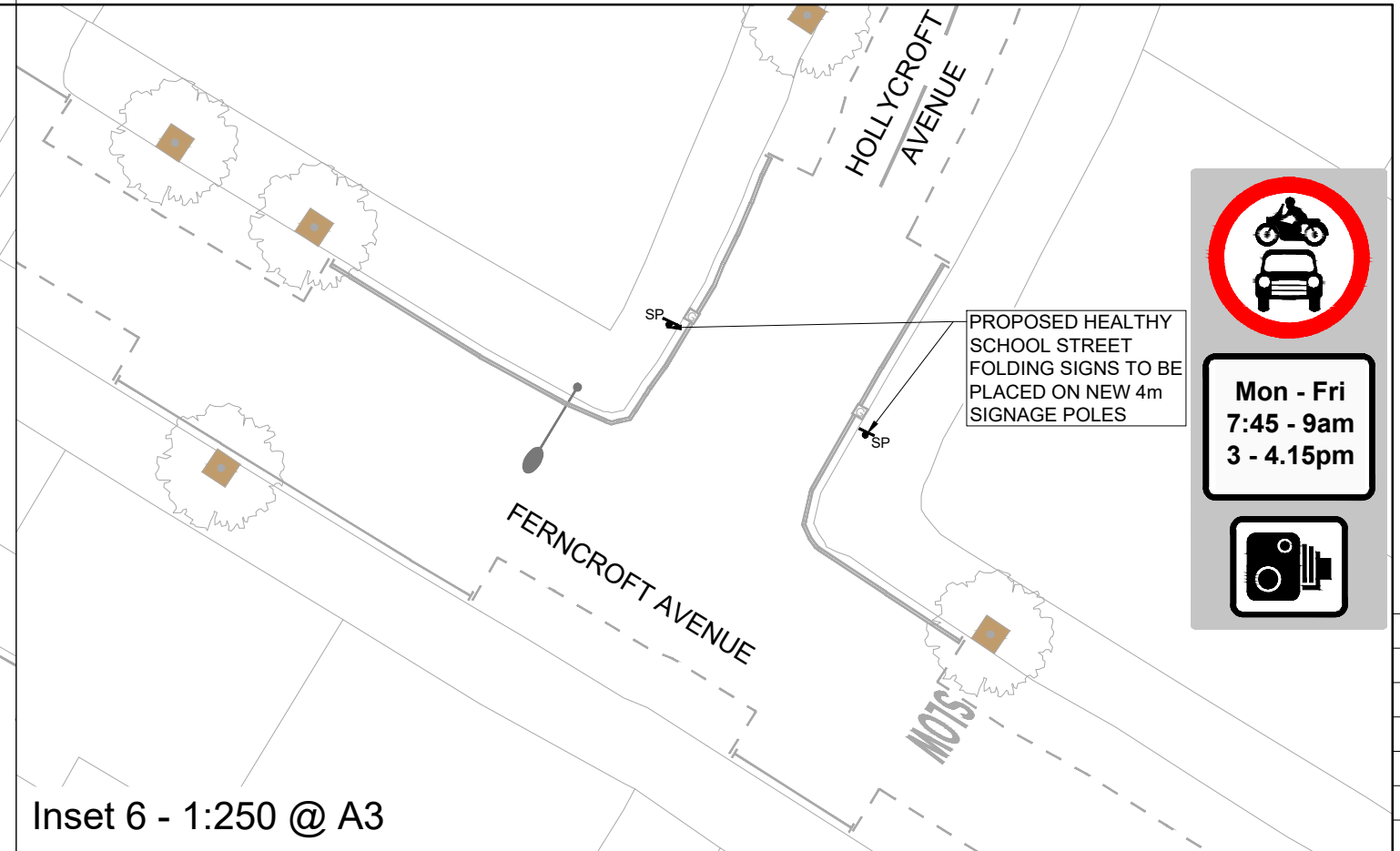

Inset 6 - 1:250 @ A3

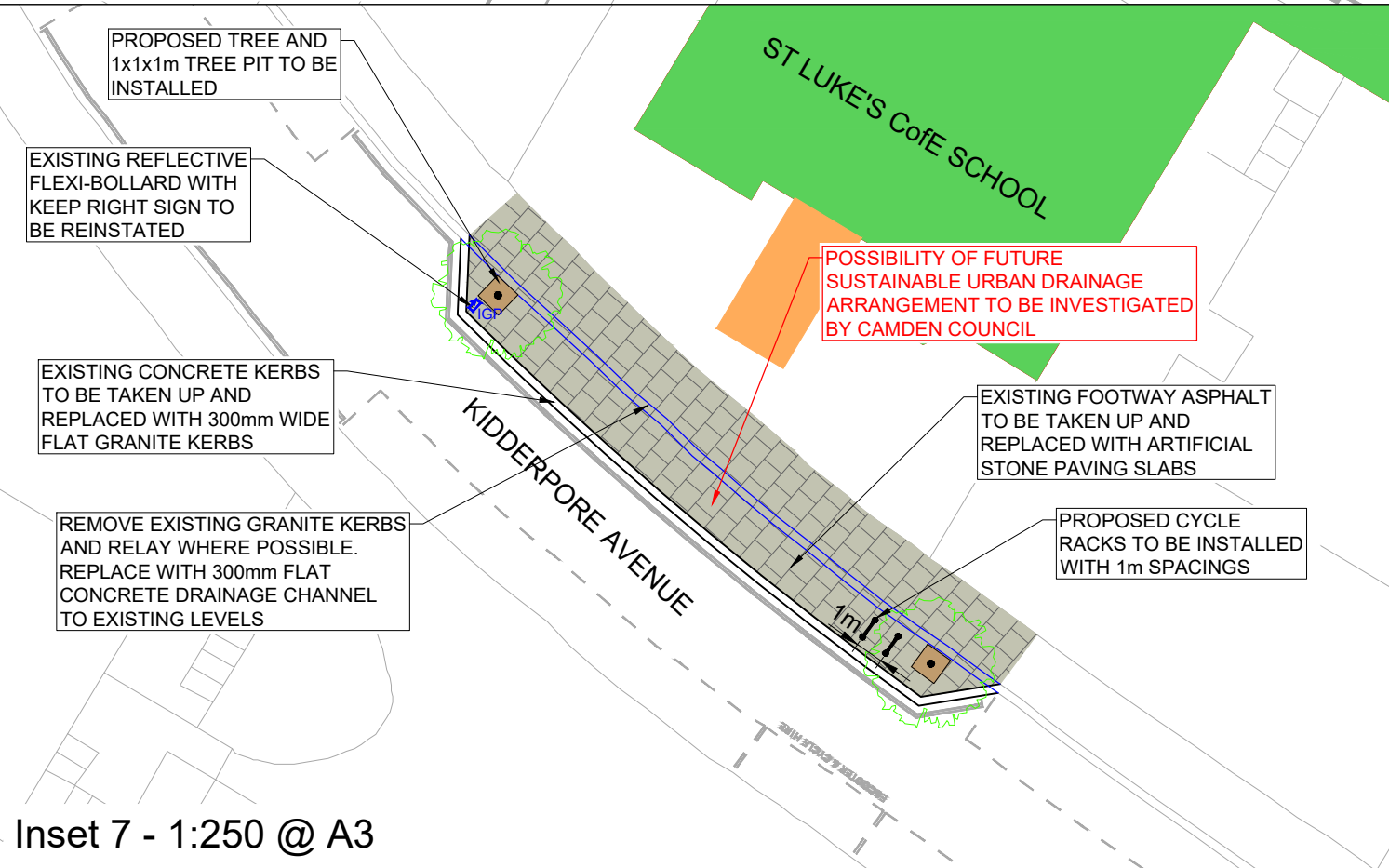

Inset 7 - 1:250 @ A3

Rev	By	Date	Amendments

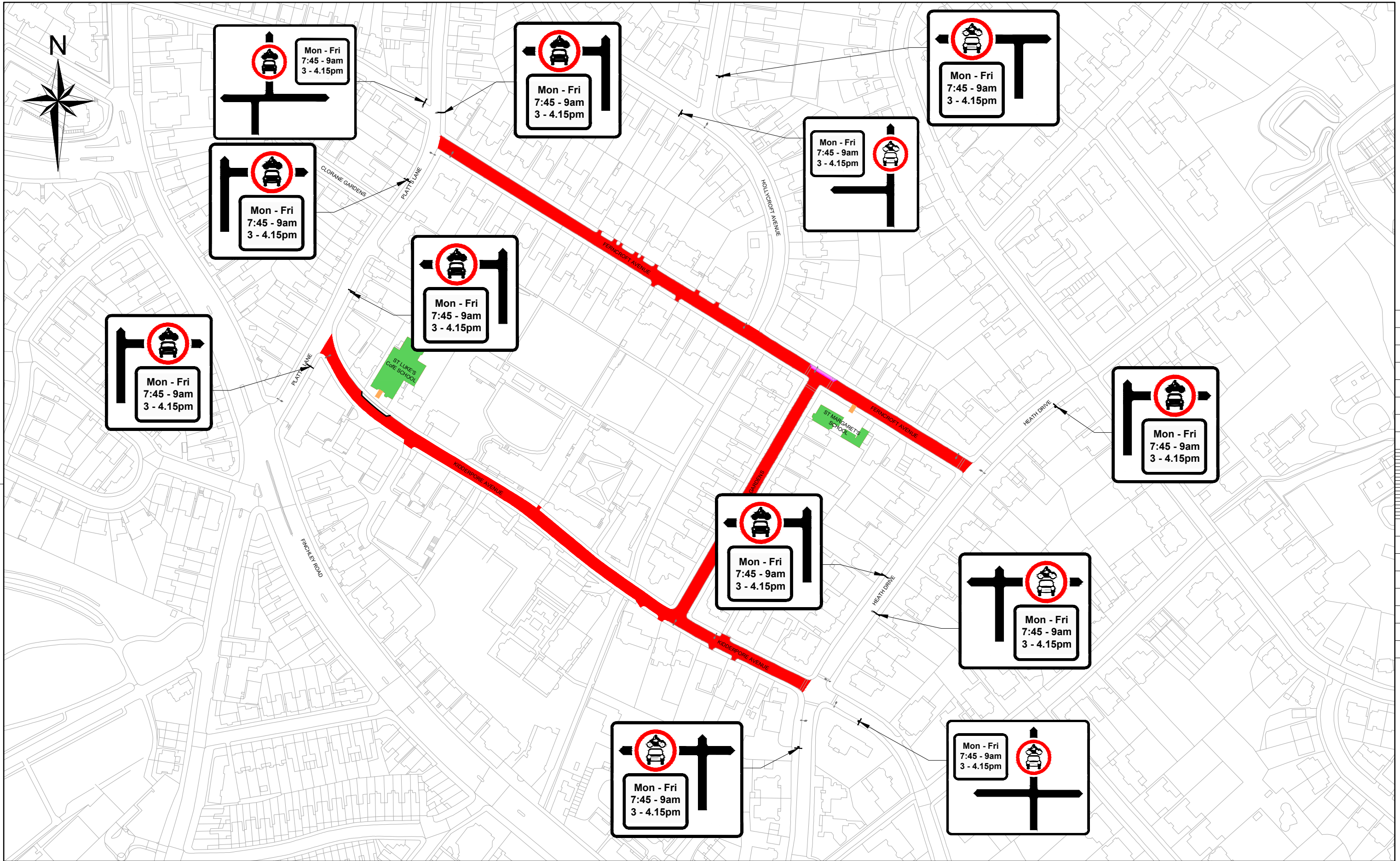

Rev	By	Date	Amendments