

SOUTH END GREEN MATTERS

Working for you all year round

Contact us

Email agent@hampsteadandkilburnconservatives.co.uk
Phone 020 7794 5679



We've been informed by TfL of major road closures and bus diversions at South End Green for the next two weeks - beginning today. This is the result of a sewer collapse under Fleet Road.

As local Conservative councillors, we were only informed of this last night, and residents on Fleet Road have expressed concern to us that this will not have been communicated effectively.

The closures can be seen on the map below: with **traffic stopped northbound on Fleet Road**, and traffic diverted via Cressy Road, Roderick Road, Constantine Road, Agincourt Road, Land awn Road.

Bus diversions

It will also affect the following bus routes for the duration of works:

- The 24 bus will start as well as stop at Fleet Road, before diverting down Constantine Road.
- The C11 bus towards Brent Cross will divert down Southampton Road, Malden Road, Prince of Wales Road, and Haverstock Hill.
- The 46 bus towards Lancaster Gate will divert very circuitously from Fleet Road down Constantine Road, Agincourt Road, Malden Road, Prince of Wales Road, and Haverstock Hill.

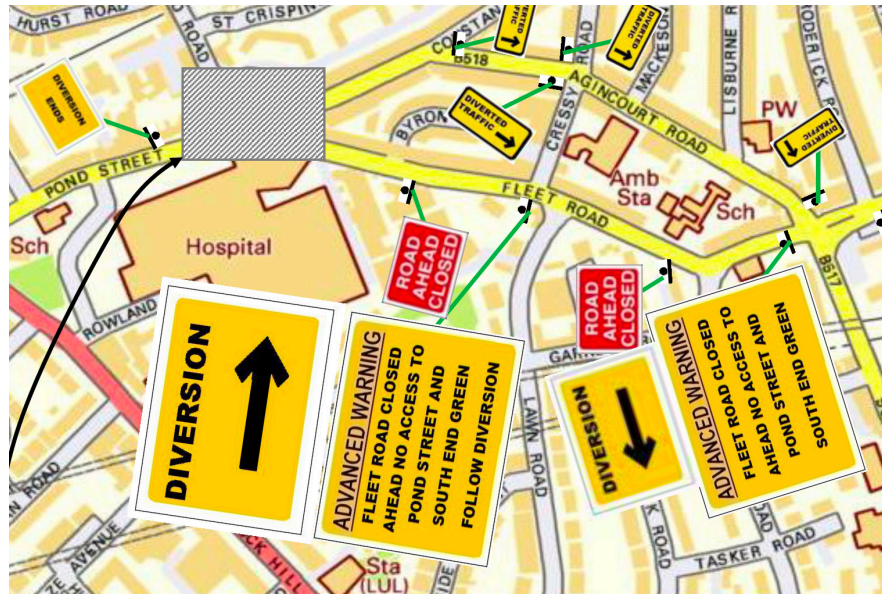

We will monitor this to ensure works are completed as soon as possible and communication improved. Please contact us if your local Conservatives can do anything for you.

Cllr Oliver Cooper
Councillor for Hampstead

oliver.cooper@camden.gov.uk

Cllr Steve Adams
Councillor for Belsize
Rona Road resident

steve.adams@camden.gov.uk

Leila Roy
Former councillor for Belsize
Savernake Road resident